



# Commercial Stainless

ITEM # \_\_\_\_\_

QTY. \_\_\_\_\_

MODEL # CTCR

## TRAFFIC CONTROL RAIL

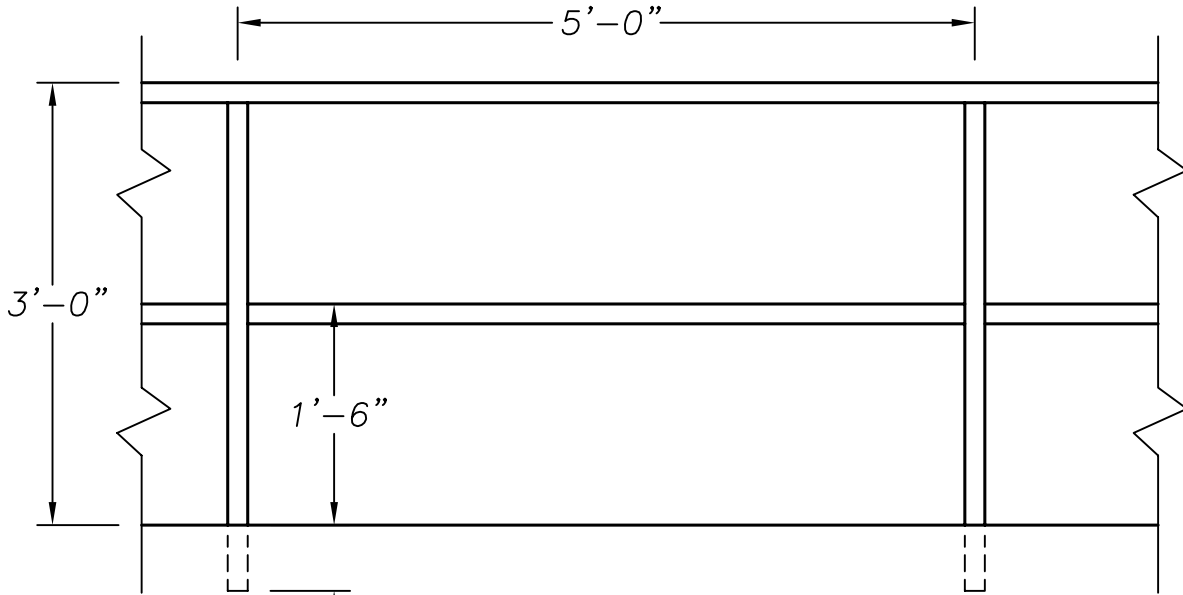

VERIFY THIS DIMENSION ONLY IF USING  
A BELOW FLOOR INSTALLATION

### SPECIFICATIONS

HANDRAIL TO BE 1 5/8" DIA. TUBING TYPE 304, 18/8 STAINLESS STEEL, POLISHED TO A # 4 SATIN FINISH. ALL SEAMS TO BE CONTINUOUSLY WELDED, GROUND SMOOTH, AND POLISHED. UPRIGHTS NOT TO EXCEED 5'-0" CENTER TO CENTER, AND TO BE SUPPLIED WITH ESCUTCHEONS FOR BOLTING TO FLOOR.

### OPTIONS

1. EXTRA LENGTH TO UPRIGHTS FOR MOUNTING BELOW FLOOR
2. RADIUS ENDS
3. 1 1/2" DIA. S/S TUBING PER A.D.A. HANDICAP HANDRAIL REQUIREMENTS
4. 1 1/4" DIA. S/S TUBING PER A.D.A. HANDICAP HANDRAIL REQUIREMENTS

955 PATTERSON DRIVE  
BLOOMSBURG, PA. 17815  
TELEPHONE: (570) 387-8980 FAX: (570) 387-8982



CUSTOM BUILT  
FOODSERVICE  
EQUIPMENT 